

PRODUCT CATALOG



Swedish Abrasives, supplier of high quality abrasive products.

Our products

We manufacture high quality abrasive products suitable for cast iron, steel, stainless steel, other non metals, concrete and stone. Abrasive products are made to trim, clean up and leave an even and smooth surface.

Every product we sell is manufactured in Sweden and the components are weighed and mixed by hand. Our products are also balanced and tested before distribution. All abrasive products from Swedish Abrasives are bound in phenolic plastic. Products from Swedish Abrasives are long lasting and suitable for customers who work with rough materials. The products are extremely time-efficient and can be used in air-powered, handheld or stationary machinery.

In our catalog we present our main products. If you are missing something in Swedish Abrasive's offer, it means that this is not a standard product, but we are used to develop new customized products for our customers. This can include rare measures or dimensions, other types of bolts or sizes, or similar.

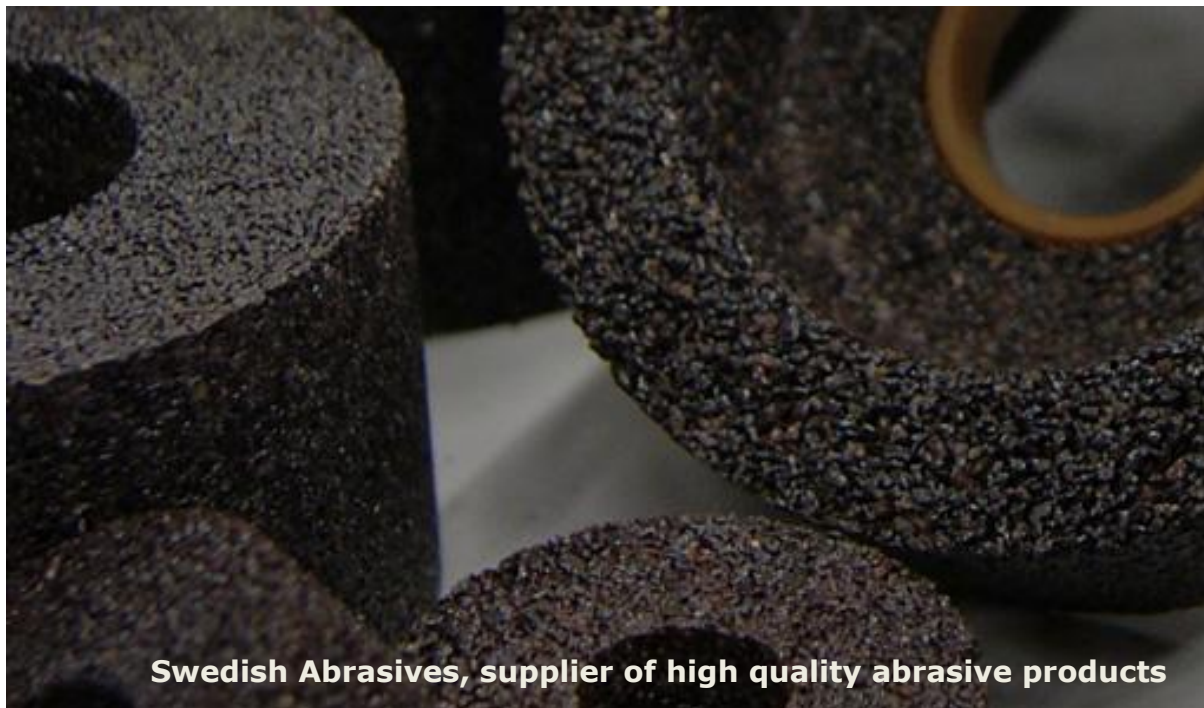

Find the right product in the catalog!

Grindstone

Type ABS, for ABS machines. Page 4

Cup wheel

Conical, Type 11, for hand-held machines. Page 5

Cup wheel

Conical, Type 5 and 6. Page 6

Grinding top

Type 15, for hand-held machines. Page 7

Grinding top

Type 18, for hand-held machines Page 8

Grinding top

Type 18R, for hand-held machines. Page 9

Grindig wheel

Type 1. Page 10

Grinding wheel

Type 14. Page 11

Grinding ring

Type 2. Page 12

Contact

You will find information about how you come in contact with Swedish Abrasives on page 13

Grindstone

Type ABS, for ABS machines.

Used in machines for grinding concrete floor.

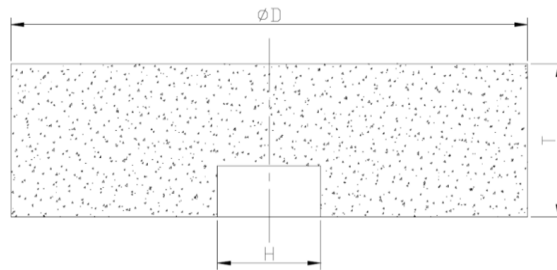

D	T	H
125	50	M16

Cup wheel

Conical, Type 11, for hand-held machines.

Used for coarse grinding of goods, edge grinding, deburring, welding, grinding of stone and concrete. Suitable for iron, steel, stainless steel, cast iron, non-metals and concrete. Max speed 50m / s. Tested accordin to EN 12413.

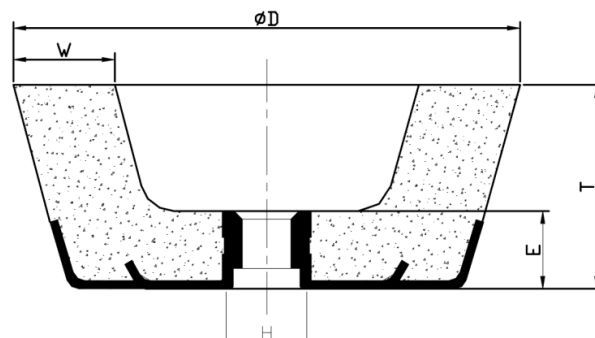

D	T	H	W	E
100	50	M14	22	20
100	50	W5/8	22	20
125	50	M14	25	20
125	50	W5/8	25	20
150	50	M14	32	20
150	50	W5/8	32	20

M14 is normally used by electric powered machines, while W5/8 is normally used by air powered ones.

Cup wheel

Conical, Type 5 and 6.

Used for coarse grinding of goods, edge grinding, deburring, welding, grinding of stone and concrete. Suitable for iron, steel, stainless steel, cast iron, non-metals and concrete. Grinding wheels are made of aluminum oxide or silicon carbide.

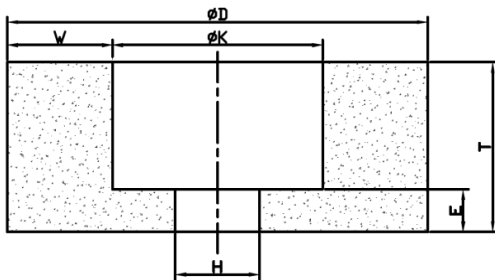

D	T	H	K	E
40	15	8	15	7
51	15	8	19	7,5
51	20	12	30	14
63	25	20	44	11
63	38	10	25	19
63	40	20	45	10
63	15	8	15	7
75	30	22	51	10
130	45	M14	65	14
150	50	20	70	34
254	32	25,4	150	19

Grinding top

Type 15, for hand-held machines.

Used for coarse grinding of goods, edge grinding, deburring, welding, grinding of stone and concrete. Suitable for iron, steel, stainless steel, cast iron, non-metals and concrete. Grinding tops are made of aluminum oxide or silicon carbide.

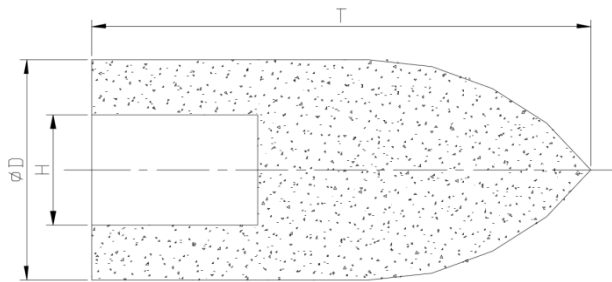

D	T	H
20	51	UNC 3/8 alt UNC 1/2 alt UNC 5/8 alt UNF 3/8 alt M10
25	51	UNC 3/8 alt UNC 1/2 alt UNC 5/8 alt UNF 3/8 alt M10
32	51	UNC 3/8 alt UNC 1/2 alt UNC 5/8 alt UNF 3/8 alt M10
32	63	UNC 3/8 alt UNC 1/2 alt UNC 5/8 alt UNF 3/8 alt M10
32	76	UNC 3/8 alt UNC 1/2 alt UNC 5/8 alt UNF 3/8 alt M10
38	63	UNC 3/8 alt UNC 1/2 alt UNC 5/8 alt UNF 3/8 alt M10
38	76	UNC 3/8 alt UNC 1/2 alt UNC 5/8 alt UNF 3/8 alt M10
44	76	UNC 3/8 alt UNC 1/2 alt UNC 5/8 alt UNF 3/8 alt M10
51	50	UNC 3/8 alt UNC 1/2 alt UNC 5/8 alt UNF 3/8 alt M10
51	60	UNC 3/8 alt UNC 1/2 alt UNC 5/8 alt UNF 3/8 alt M10
51	76	UNC 3/8 alt UNC 1/2 alt UNC 5/8 alt UNF 3/8 alt M10
51	102	UNC 3/8 alt UNC 1/2 alt UNC 5/8 alt UNF 3/8 alt M10
63	76	UNC 3/8 alt UNC 1/2 alt UNC 5/8 alt UNF 3/8 alt M10
63	102	UNC 3/8 alt UNC 1/2 alt UNC 5/8 alt UNF 3/8 alt M10
75	89	UNC 3/8 alt UNC 1/2 alt UNC 5/8 alt UNF 3/8 alt M10
75	102	UNC 3/8 alt UNC 1/2 alt UNC 5/8 alt UNF 3/8 alt M10

Grinding top

Type 18, for hand-held machines.

Used for coarse grinding of goods, edge grinding, deburring, welding, grinding of stone and concrete. Suitable for iron, steel, stainless steel, cast iron, non-metals and concrete. Grinding tops are made of aluminum oxide or silicon carbide.

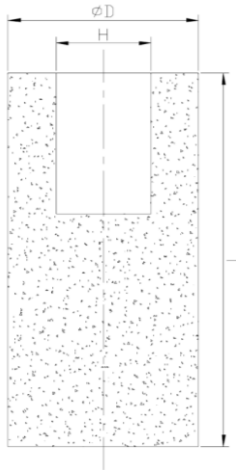

D	T	H
20	51	UNC 3/8 alt UNC 1/2 alt UNC 5/8 alt UNF 3/8 alt M10
25	51	UNC 3/8 alt UNC 1/2 alt UNC 5/8 alt UNF 3/8 alt M10
32	51	UNC 3/8 alt UNC 1/2 alt UNC 5/8 alt UNF 3/8 alt M10
32	63	UNC 3/8 alt UNC 1/2 alt UNC 5/8 alt UNF 3/8 alt M10
32	76	UNC 3/8 alt UNC 1/2 alt UNC 5/8 alt UNF 3/8 alt M10
38	63	UNC 3/8 alt UNC 1/2 alt UNC 5/8 alt UNF 3/8 alt M10
38	76	UNC 3/8 alt UNC 1/2 alt UNC 5/8 alt UNF 3/8 alt M10
44	76	UNC 3/8 alt UNC 1/2 alt UNC 5/8 alt UNF 3/8 alt M10
51	50	UNC 3/8 alt UNC 1/2 alt UNC 5/8 alt UNF 3/8 alt M10
51	60	UNC 3/8 alt UNC 1/2 alt UNC 5/8 alt UNF 3/8 alt M10
51	76	UNC 3/8 alt UNC 1/2 alt UNC 5/8 alt UNF 3/8 alt M10
51	102	UNC 3/8 alt UNC 1/2 alt UNC 5/8 alt UNF 3/8 alt M10
63	76	UNC 3/8 alt UNC 1/2 alt UNC 5/8 alt UNF 3/8 alt M10
63	102	UNC 3/8 alt UNC 1/2 alt UNC 5/8 alt UNF 3/8 alt M10
75	89	UNC 3/8 alt UNC 1/2 alt UNC 5/8 alt UNF 3/8 alt M10
75	102	UNC 3/8 alt UNC 1/2 alt UNC 5/8 alt UNF 3/8 alt M10

Grinding top

Type 18R, for hand-held machines.

Used for coarse grinding of goods, edge grinding, deburring, welding, grinding of stone and concrete. Suitable for iron, steel, stainless steel, cast iron, non-metals and concrete. Grinding tops are made of aluminum oxide or silicon carbide.

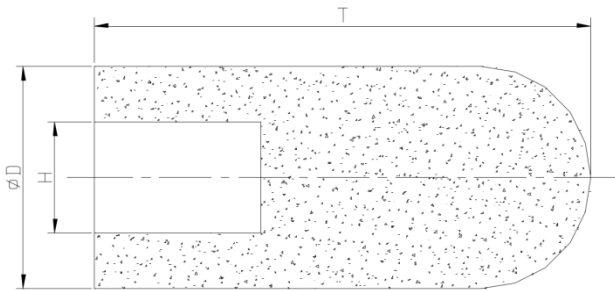

D	T	H
20	51	UNC 3/8 alt UNC 1/2 alt UNC 5/8 alt UNF 3/8 alt M10
25	51	UNC 3/8 alt UNC 1/2 alt UNC 5/8 alt UNF 3/8 alt M10
32	51	UNC 3/8 alt UNC 1/2 alt UNC 5/8 alt UNF 3/8 alt M10
32	63	UNC 3/8 alt UNC 1/2 alt UNC 5/8 alt UNF 3/8 alt M10
32	76	UNC 3/8 alt UNC 1/2 alt UNC 5/8 alt UNF 3/8 alt M10
38	63	UNC 3/8 alt UNC 1/2 alt UNC 5/8 alt UNF 3/8 alt M10
38	76	UNC 3/8 alt UNC 1/2 alt UNC 5/8 alt UNF 3/8 alt M10
44	76	UNC 3/8 alt UNC 1/2 alt UNC 5/8 alt UNF 3/8 alt M10
51	50	UNC 3/8 alt UNC 1/2 alt UNC 5/8 alt UNF 3/8 alt M10
51	60	UNC 3/8 alt UNC 1/2 alt UNC 5/8 alt UNF 3/8 alt M10
51	76	UNC 3/8 alt UNC 1/2 alt UNC 5/8 alt UNF 3/8 alt M10
51	102	UNC 3/8 alt UNC 1/2 alt UNC 5/8 alt UNF 3/8 alt M10
63	76	UNC 3/8 alt UNC 1/2 alt UNC 5/8 alt UNF 3/8 alt M10
63	102	UNC 3/8 alt UNC 1/2 alt UNC 5/8 alt UNF 3/8 alt M10
75	89	UNC 3/8 alt UNC 1/2 alt UNC 5/8 alt UNF 3/8 alt M10
75	102	UNC 3/8 alt UNC 1/2 alt UNC 5/8 alt UNF 3/8 alt M10

Grindig wheel

Type 1.

Used for coarse grinding of goods, edge grinding, deburring, welding, grinding of stone and concrete. Suitable for iron, steel, stainless steel, cast iron, non-metals and concrete. Grinding wheels are made of aluminum oxide or silicon carbide. Also available as reinforced.

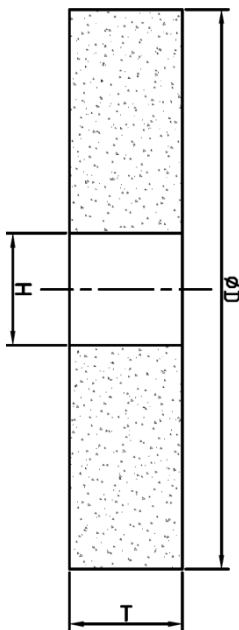

D

Från 38 till 300

T

Från 2 till 51

H

Från 6 till 51

Grinding wheel

Type 14.

Used for coarse grinding of goods, edge grinding, deburring, welding, grinding of stone and concrete. Suitable for iron, steel, stainless steel, cast iron, non-metals and concrete. Grinding wheels are made of aluminum oxide or silicon carbide.

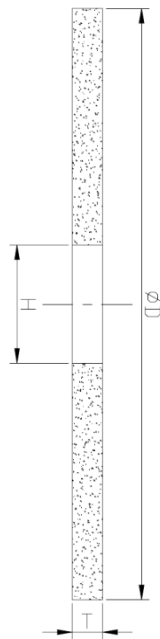

D

Från 38 till 300

T

Från 2 till 51

H

Från 6 till 51

Grinding wheel

Type 2.

Used for coarse grinding of goods, edge grinding, deburring, welding, grinding of stone and concrete. Suitable for iron, steel, stainless steel, cast iron, non-metals and concrete. Grinding wheels are made of aluminum oxide or silicon carbide.

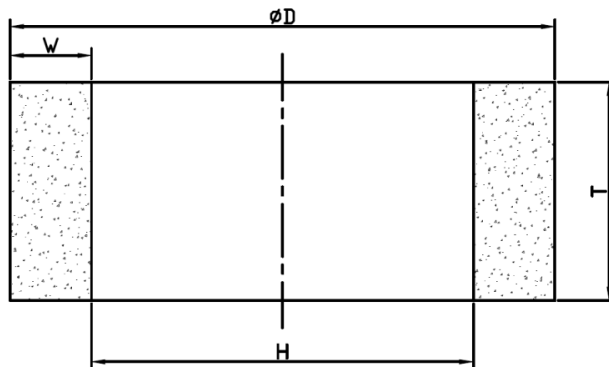

D	T	H	Fit
125	60	55	4 x M8
125	63	55	4 x M8
240	51	135	4 x M10
240	51	135	4 x UNC 3/8
250	102	200	
252	24	152	
256	80	155	4 x UNC 1/2
280	51	160	4 x UNC 5/8

Contact

Contact Swedish Abrasives for more information if you want to make a special order with specific properties of any product. We are used to manufacture abrasive products according to customers' requests.

You can reach us most easily by visiting us at www.swedishabrasives.se or by telephone.



www.swedishabrasives.se | info@swedishabrasives.se | Tel 036-185007 | Fax 036-185008